

EXTENDS TO A  
MAXIMUM LENGTH  
OF  
[1828.8]  
6'

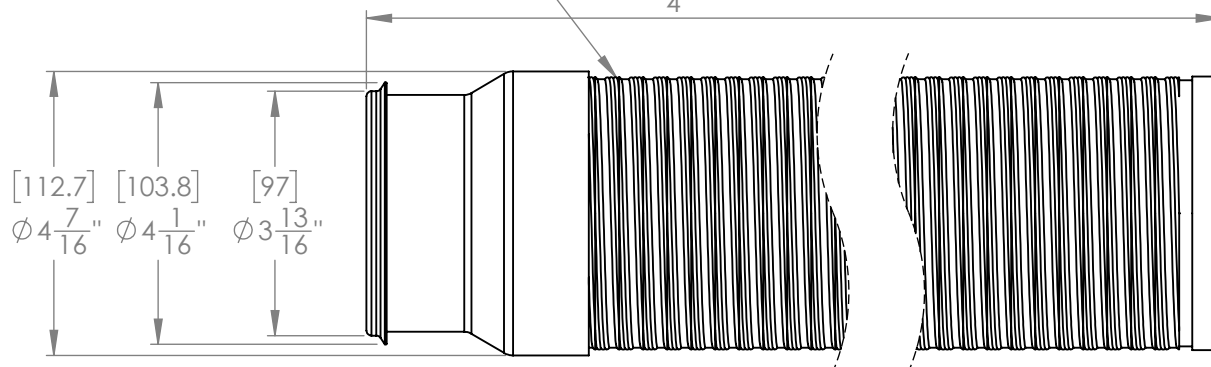

[755.1]  
29 <sup>3</sup>/<sub>4</sub>" FULLY COMPRESSED



[102]  
Ø 4"

[89.5]  
Ø 3 <sup>1</sup>/<sub>2</sub>"

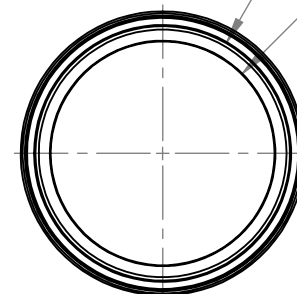

**FOR REFERENCE ONLY**

| REVISION | DESCRIPTION :  |
|----------|--|
| 00       | VT0616 - 4" x 6' Quick Connect Hook-up, Semi-Rigid, UL |

PROPRIETARY AND CONFIDENTIAL

THE INFORMATION CONTAINED IN THIS DRAWING IS THE SOLE PROPERTY OF Imperial Manufacturing Group. ANY REPRODUCTION IN PART OR AS A WHOLE WITHOUT THE WRITTEN PERMISSION OF Imperial Manufacturing Group IS PROHIBITED.

|   |      |                      |   |                        |
|---|------|----------------------|---|------------------------|
|   | NAME | DATE                 | TITLE:  |                        |
| DRAWN   | ER   | 2018-08-16           | 4" x 6' Quick Connect Hook-up, Semi-Rigid, UL |                        |
| UNLESS OTHERWISE SPECIFIED:<br>DIMENSIONS ARE IN MM<br>TOLERANCES: +/- 1.588mm<br>+/- 1/16" |      |                      | MATERIAL:<br>Aluminum                         | FINISH:<br>Mill Finish |
| SIZE<br><b>A</b>  |      |                      | PART NO.<br>VT0616                            |                        |
| SCALE: 1:3  |      | DO NOT SCALE DRAWING |   | SHEET 1 OF 1           |



*Imperial*  
Manufacturing Group